



## KEILOR 190 (3+2) – URBAN FACADE

FAÇADE IS FOR ILLUSTRATION PURPOSES ONLY. FACE BRICK ONLY TO THE FRONT FAÇADE – RENDER NOT INCLUDED

 3+2  2+1  1+1  1+1

LOT 21 CRONIN STREET,  
MORAYFIELD HEIGHTS

Land Size	401 m <sup>2</sup>
Land Price	\$214,000
Registration	Registered
House Size	189.44 m <sup>2</sup>
House Price	\$285,985

TOTAL FIXED TURNKEY PRICE:

# \$499,985

### PACKAGE HIGHLIGHTS

- ✓ Full Turnkey, Fixed Price, Gold Inclusions
- ✓ **Face brick to front façade with lightweight cladding to sides & rear**
- ✓ Exposed aggregate driveway & turfing to entire lot
- ✓ Full timber paling fencing and landscaping package
- ✓ Three coat Dulux premium paint system
- ✓ Quality floor coverings - carpet & tiles throughout
- ✓ Superior LED lighting package throughout entire house (excl. garage)
- ✓ Designer kitchen with Westinghouse stainless steel cooktop, oven & range hood
- ✓ Overhead cupboards & stainless-steel dishwasher
- ✓ 3 x split system air conditioners
- ✓ Ceramic tiled splashbacks to kitchens & laundries
- ✓ 20mm stone benchtops to kitchens and bathrooms
- ✓ Developer and covenant approval
- ✓ Building approval and water application fees included
- ✓ Colorbond roof & barrier screens to windows & doors
- ✓ Ceiling fans in every bedroom, living area & alfresco
- ✓ Approved Fire Separation wall between Dwelling A & B
- ✓ 20 Year Structural Guarantee

# KEILOR 190 (3+2)

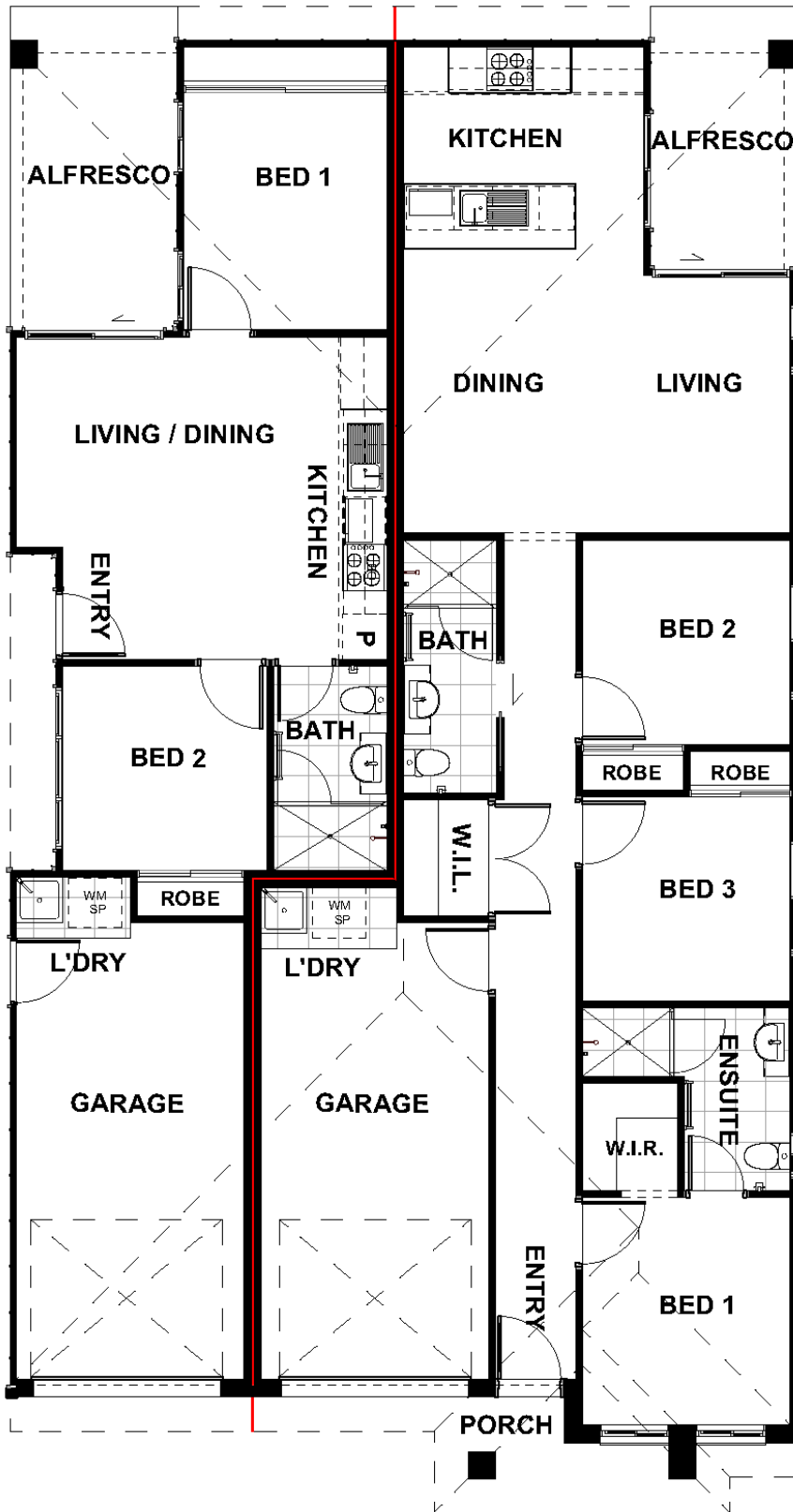

## Dwelling A:

Living	83.01 m <sup>2</sup>
Garage	20.78 m <sup>2</sup>
Porch	2.50 m <sup>2</sup>
Alfresco	5.79 m <sup>2</sup>
<b>Total</b>	<b>112.08 m<sup>2</sup></b>

## Dwelling B:

Living	44.90 m <sup>2</sup>
Garage	21.16 m <sup>2</sup>
Porch	2.36 m <sup>2</sup>
Alfresco	8.94 m <sup>2</sup>
<b>Total</b>	<b>77.36 m<sup>2</sup></b>
<b>Grand Total</b>	<b>189.44 m<sup>2</sup></b>